

FS621M DMLS METAL 3D PRINTER

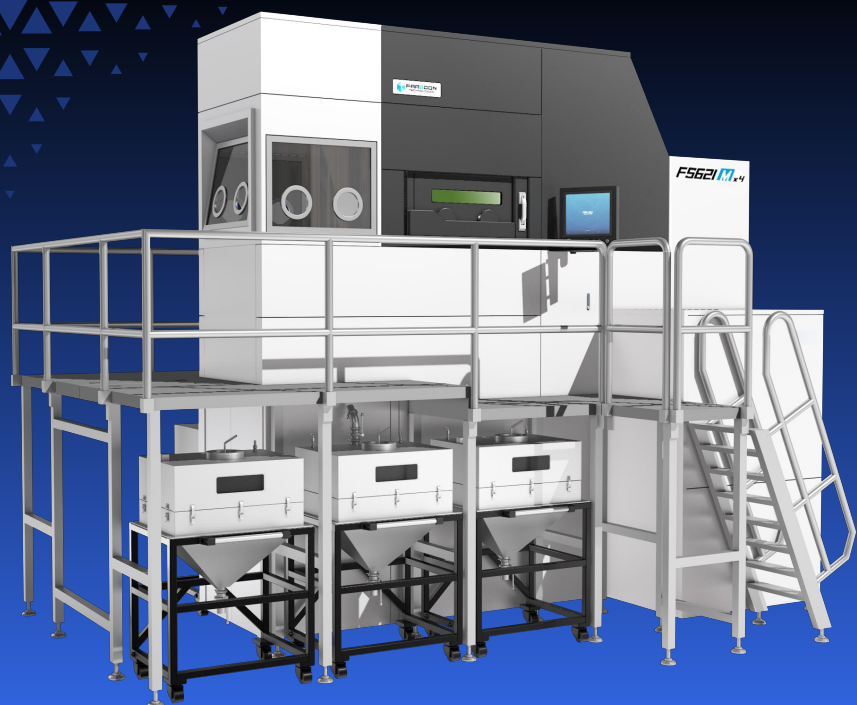

Industrial Scale Metal Laser
Sintering System with 1.1 Meter Z
Height

Truly open industrial grade DMLS platform

Advanced Production Features

REPEATABLE, HIGH-QUALITY PARTS



Automotive



Aerospace



Consumer Products



Mold



Medical & Dental

YOUR PRODUCTION TOOLS FOR INDUSTRIAL METAL AM

We provide top-tier industrial-grade metal DMLS systems, materials, and software. Our solutions offer unmatched flexibility in machine operation and material selection, with open parameter sets and multi-laser technology.

METAL MATERIALS

Qualified Metal Material Solutions. More than 16 alloys over 68 validated processing parameters.

Offer a higher level of customized solutions that can be tailored to your specific material and application needs.

316L, TA15, Ti6Al4V, AlSi10Mg*, IN718*, HX*, Maraging Steel Grade 300*, IN625, 420, 15-5H, 17-43P, CoCrMo, CoCrMoW, CuSn10, Pure Copper, Tungsten, Tantalum.

FS621M DMLS METAL 3D PRINTER

**EXTENSIVE BUILD ENVELOPE 24.4 x
24.4 x 43.3 IN**

**HIGH THROUGHPUT WITH UP TO
QUAD 500-WATT LASERS**

**MODULAR DESIGN CONCEPT OFFERS
EASE OF OPERATION**

TECHNICAL DATA	FS621M	FS621M-4
External Dimensions (LxWxH)	5800x4300x4000 mm (228.3x169.3x157.5 in)	
Build Cylinder Size (1 LxWxH)	620x620x1100mm (24.4 x 24.4 x 43.3 in) (not including build plate thickness)	
Net Weight	Approx. 9000 kg (19841.6 lb)	
Layer Thickness	0.02~0.1 mm (0.0008-0.0039 in)	
Scanning Speed	Max. 15.2 m/s (49.9 ft/s)	
Laser Type	Single Laser, 1x1000W	Quad Lasers, 4x500W
Scanner	F theta lenses or dynamic focusing system	
Inert Gas Protection	Argon/Nitrogen	
Average Inert Gas Consumption in Process	8 - 10 L / min	
Operating System	64 bit Windows 10	
Comprehensive Software	BuildStar, MakeStar®	
Key Software Features	Open machine key parameters, real-time build parameter modification, three-dimensional visualization, diagnostic functions	
Data File Format	STL	
Data File Format	STL	
Power Supply	EUR/China: 400V±10%, 3~/N/PE, 50Hz, 40A US: transformer sold with machine	
Operating Ambient Temperature	22-28°C (71.6-82.4°F)	
Materials ²	IN718, HX, AISi10Mg, HAYNES 230*, TA15*, Ti6Al4V*, IN625*, 316L*, more materials to come	

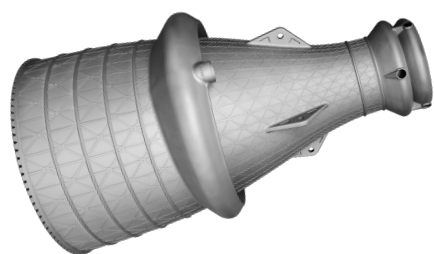

Engine Components



Industry Application-Jewelry



Automotive Front and Rear Hub Integration

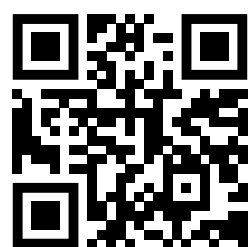

Additive Plus combines technology, expertise, and a personal touch to deliver various 3D printing services and products: 3D printers, 3D scanners, atomizers, industrial vacuums, laboratory and analytical instruments, industrial machinery, furnaces, software, materials and many more. Local engineering and maintenance team. Flexible payments terms available. We aim to empower everyone to live their additive journey effectively.

Additive Plus (A Plus Industrial LLC) | +1 (888) 797-7784 | +1 (747) 351-1640 | info@additiveplus.com | www.additiveplus.com



Sustainable
3D Manufacturing